

Gardner-Webb University

Digital Commons @ Gardner-Webb University

First Baptist Church Building History &
Historical Documents

First Baptist Church (Shelby, NC)

1973

1973 Sanctuary Renovation Letter - Copies of Floor Plans

Gene L. Watterson

Follow this and additional works at: <https://digitalcommons.gardner-webb.edu/baptist-historical-collections-first-baptist-church-building-history-and-historical-documents>

FIRST BAPTIST CHURCH
FIRST BAPTIST CHURCH

120 NORTH LaFAYETTE STREET

SHELBY, N. C.

28150

GENE L. WATTERSON
Senior Minister

ROLAND LEATH
Associate Minister
ROLAND LEATH
Associate Minister
VAN H. RAMSEY
Minister of Music

MISS MARY SUE THOMPSON
Church Secretary
MISS MARY SUE THOMPSON
Church Secretary
MRS. JAMES B. SPEARS
Educational Secretary
MRS. DAVID R. COUCH
Music and Youth Secretary

Dear friend,

Your Planning and Building Committee instructed me to send to each of you a copy of the floor plans and the artist's concept of the interior of our sanctuary in order that you may be thoroughly familiar with these plans prior to the meeting on this Sunday morning at ten-fifteen. (Attend your Sunday School class at nine-forty, then come to the sanctuary.) Much time and thought has gone into this design and your committee feels that this is the maximum possible usage of the space available. Of course, lines on paper do not really tell the whole story, so a more full explanation will be given Sunday as to the size of the spaces indicated and their possible usages.

It is exciting to be a part of the First Baptist Church in these days as we endeavor to enlarge our facilities that in turn our ministries to the youth and community may be enlarged. These things are possible because of your dedication and will be achieved in a relatively short period through your prayers and generosity.

Consider the enclosed information carefully and prayerfully and then be present on Sunday morning both to receive the more full explanation and to cast your vote.

Sincerely yours,

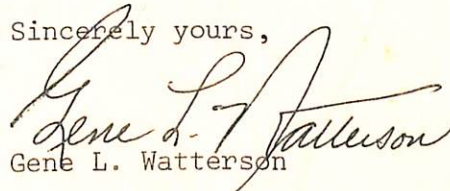
Gene L. Watterson

January nineteenth.

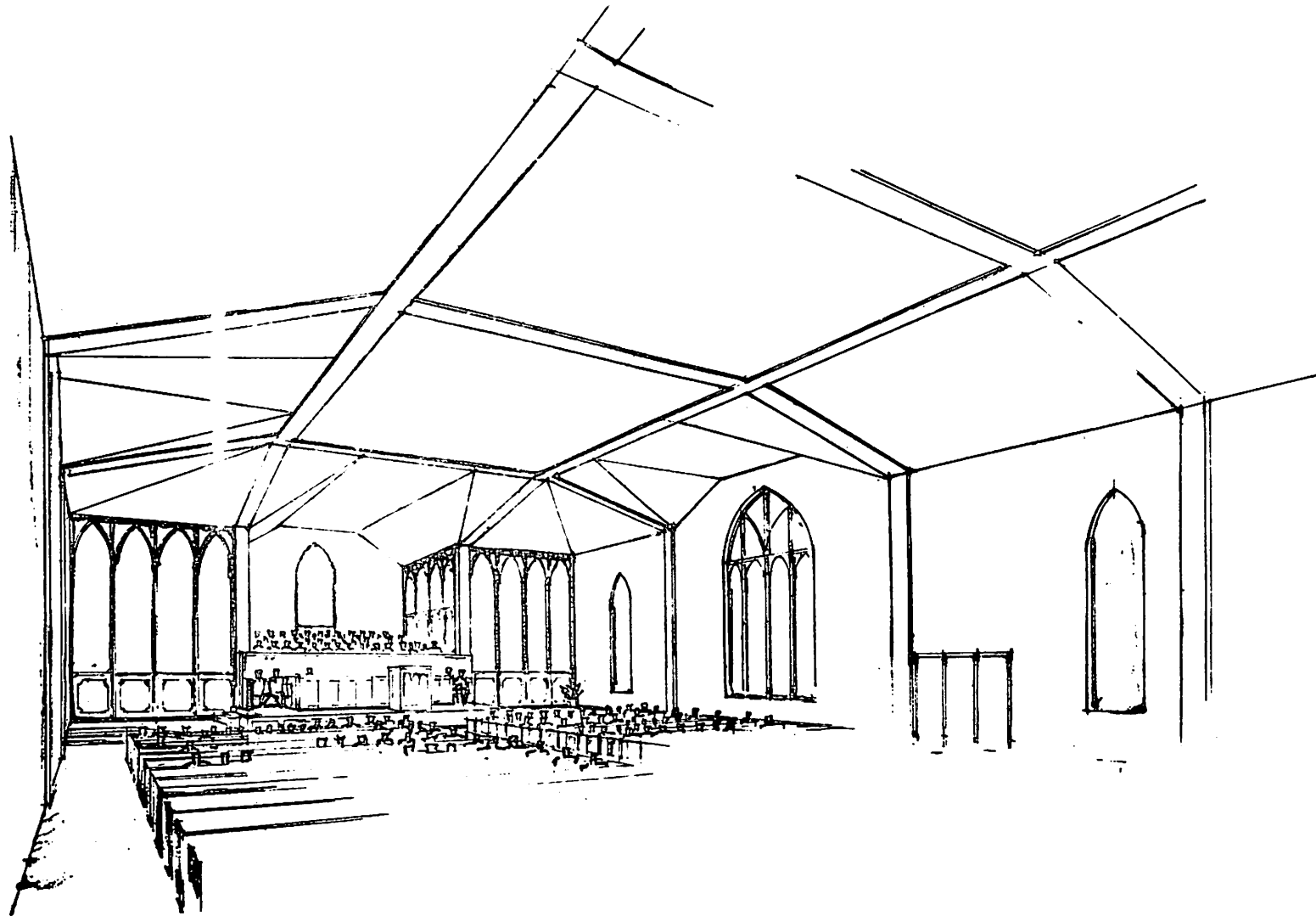

WILBER, KENDRICK, WORKMAN AND WARREN
ARCHITECTS-ENGINEERS CHARLOTTE, NORTH CAROLINA

FIRST BAPTIST CHURCH
SHELBY, NORTH CAROLINA

INTERIOR STUDY

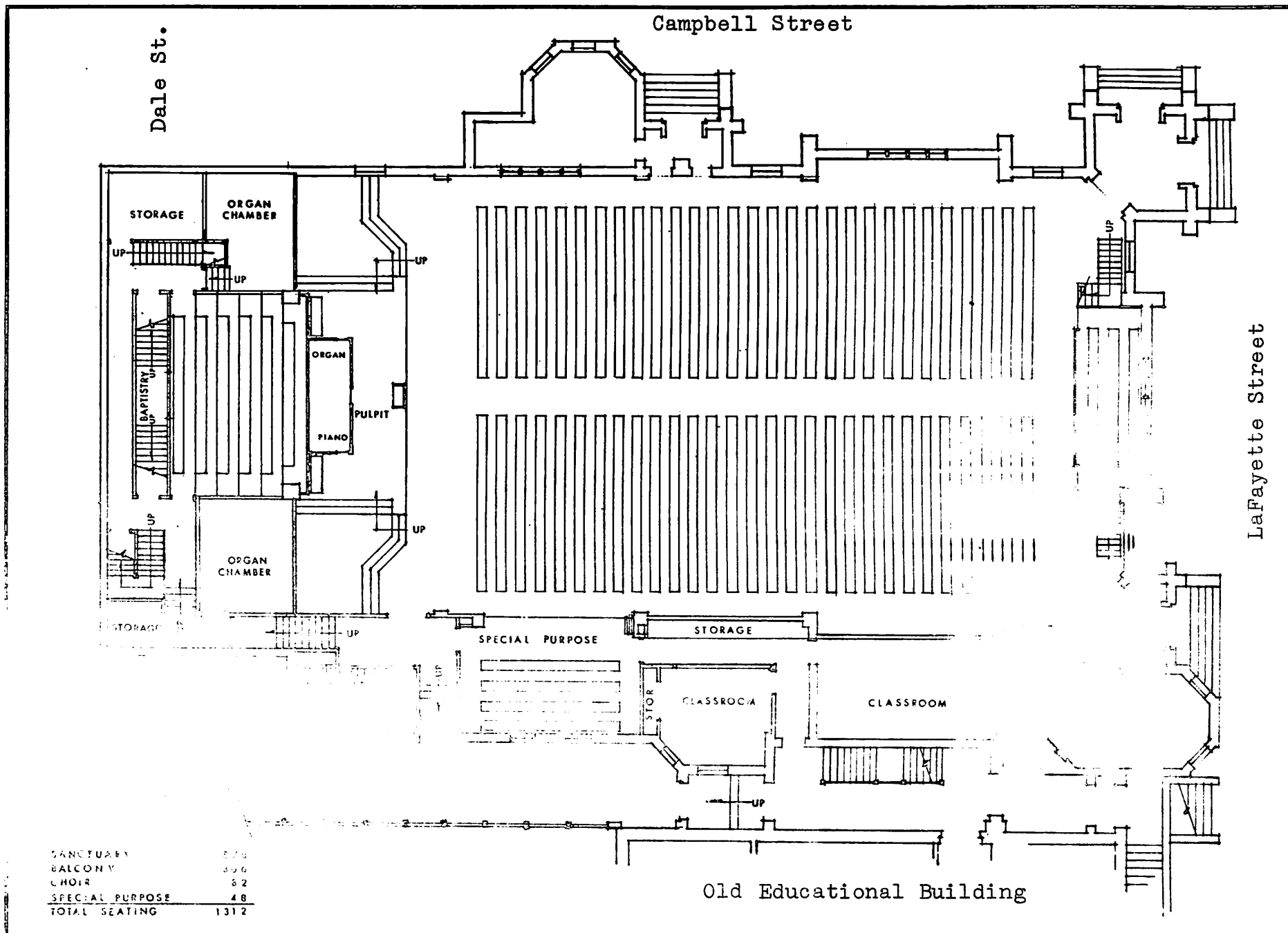

SANCTUARY	576
BALCONY	396
CHOIR	52
SPECIAL PURPOSE	48
TOTAL SEATING	1312

Old Educational Building

WILBER, KENDRICK, WORKMAN AND WARREN
ARCHITECTS
CHARLOTTE, NORTH CAROLINA

FIRST BAPTIST CHURCH
SHELBY, NORTH CAROLINA

FIRST FLOOR

REVISED	CHARTER NO.
DATE JAN. 14, 1971	2
CORREL. NO. 391	OF TOTAL 3

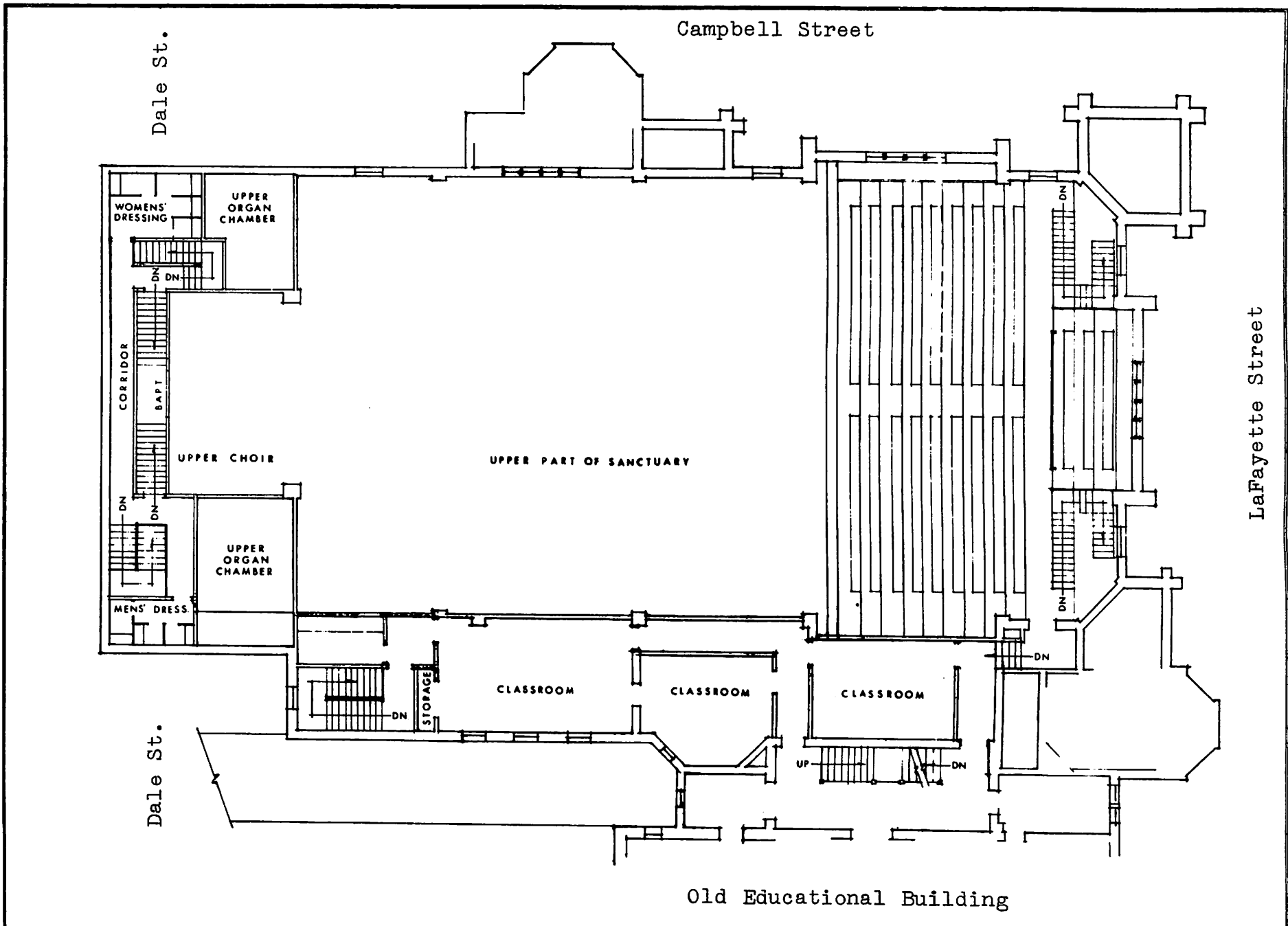

WILBER, KENDRICK, WORKMAN AND WARREN
 ARCHITECTS
 CHARLOTTE, NORTH CAROLINA

FIRST BAPTIST CHURCH
 SHELBY, NORTH CAROLINA

REVISED	DIBBY NO.
DATE JAN 14, 1971	3
CONTR. NO. 391	CP
SECOND FLOOR	TOTAL 3

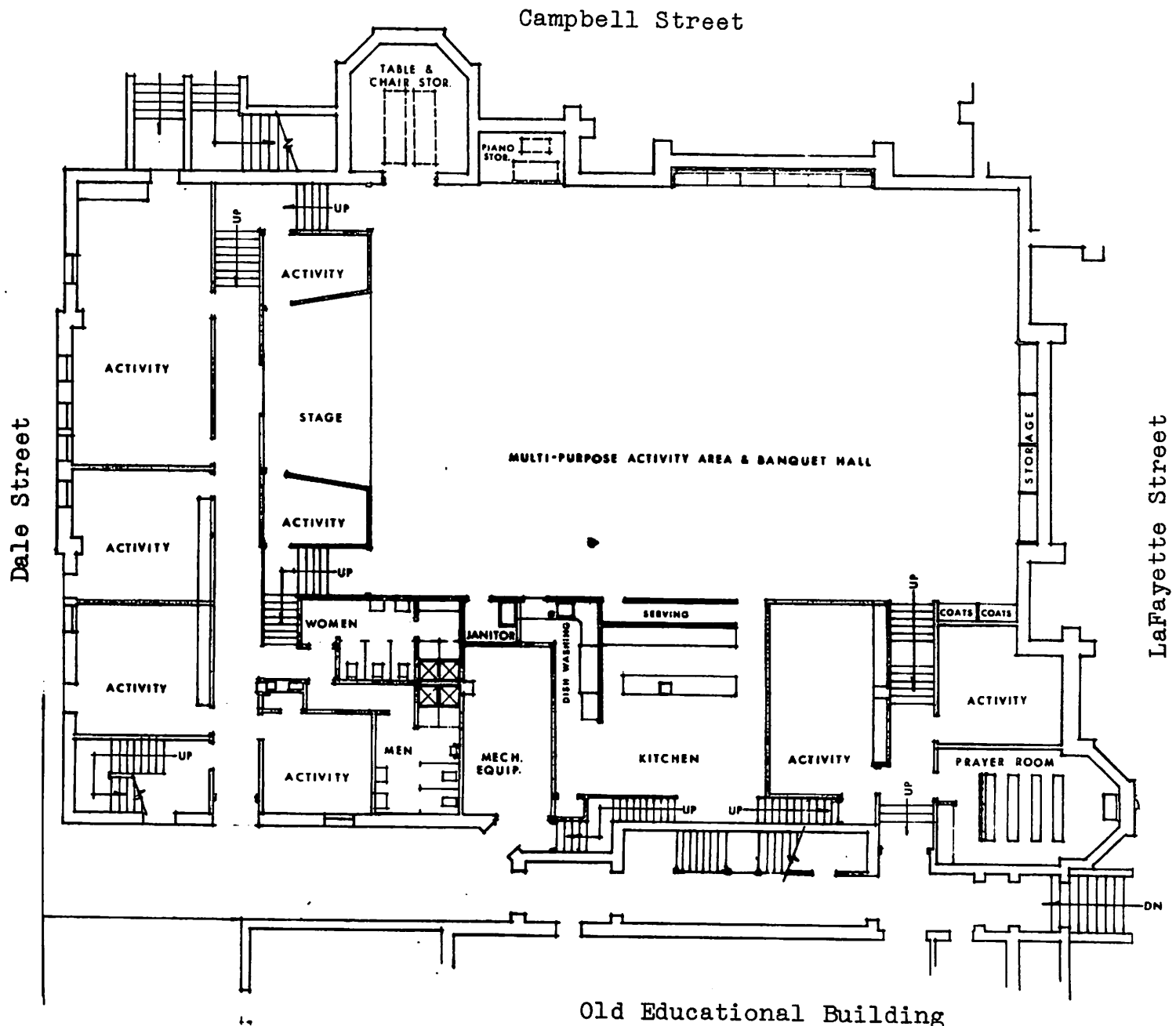

Old Educational Building

WILBER, KENDRICK, WORKMAN AND WARREN
 ARCHITECTS
 CHARLOTTE, NORTH CAROLINA

FIRST BAPTIST CHURCH
 SHELBY, NORTH CAROLINA

REVISION	CHECK NO.
DATE JAN 14, 1971	1
CONTRACT NO. 391	GP TOTAL 3

GROUND FLOOR