

Gardner-Webb University

## Digital Commons @ Gardner-Webb University

---

First Baptist Church Building History &  
Historical Documents

First Baptist Church (Shelby, NC)

---

1973

### 1973- Sanctuary Renovations Floor plans

Wilber, Kendrick, Workman, Warren Architects

Follow this and additional works at: <https://digitalcommons.gardner-webb.edu/baptist-historical-collections-first-baptist-church-building-history-and-historical-documents>

---

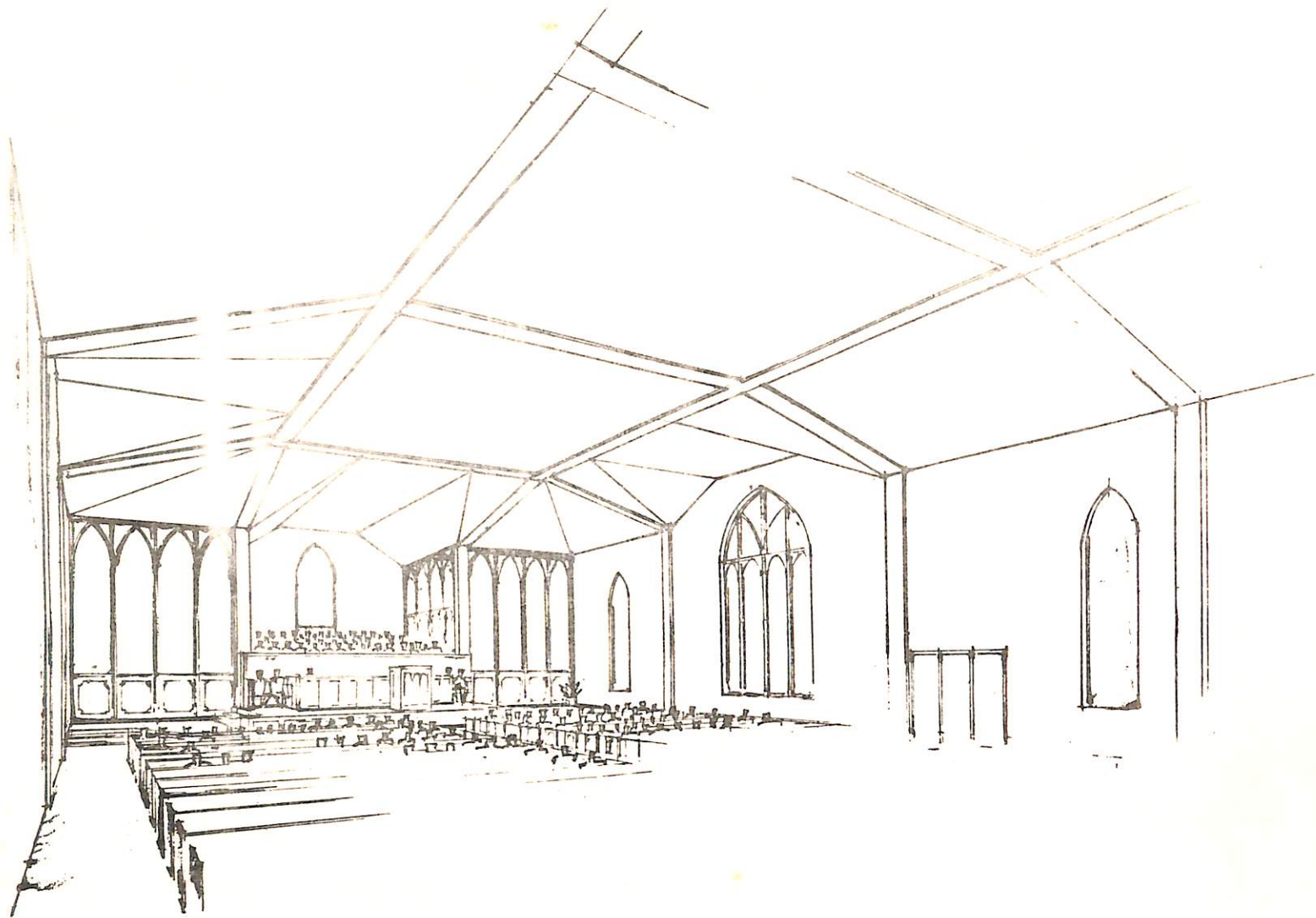

WILBER, KENDRICK, WORKMAN AND WARREN  
ARCHITECTS-ENGINEERS CHARLOTTE, NORTH CAROLINA

FIRST BAPTIST CHURCH  
SHELBY, NORTH CAROLINA

INTERIOR STUDY

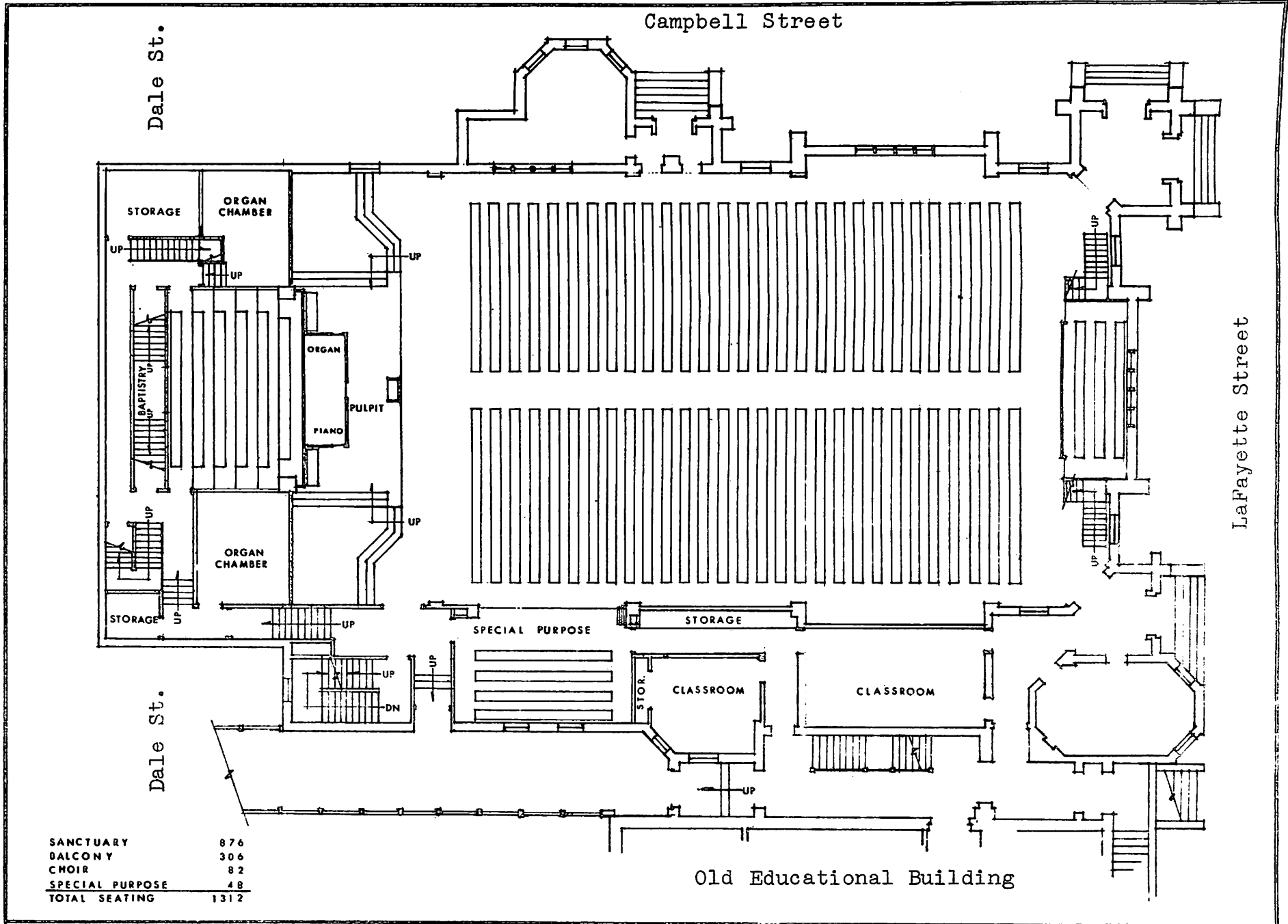

**WILBER, KENDRICK, WORKMAN AND WARREN**  
 ARCHITECTS  
 CHARLOTTE, NORTH CAROLINA

**FIRST BAPTIST CHURCH**  
 SHELBY, NORTH CAROLINA

FIRST FLOOR

REVISED	CHECK NO.
DATE JAN 14, 1971	2
DRAWING NO. 391	OF TOTAL 3

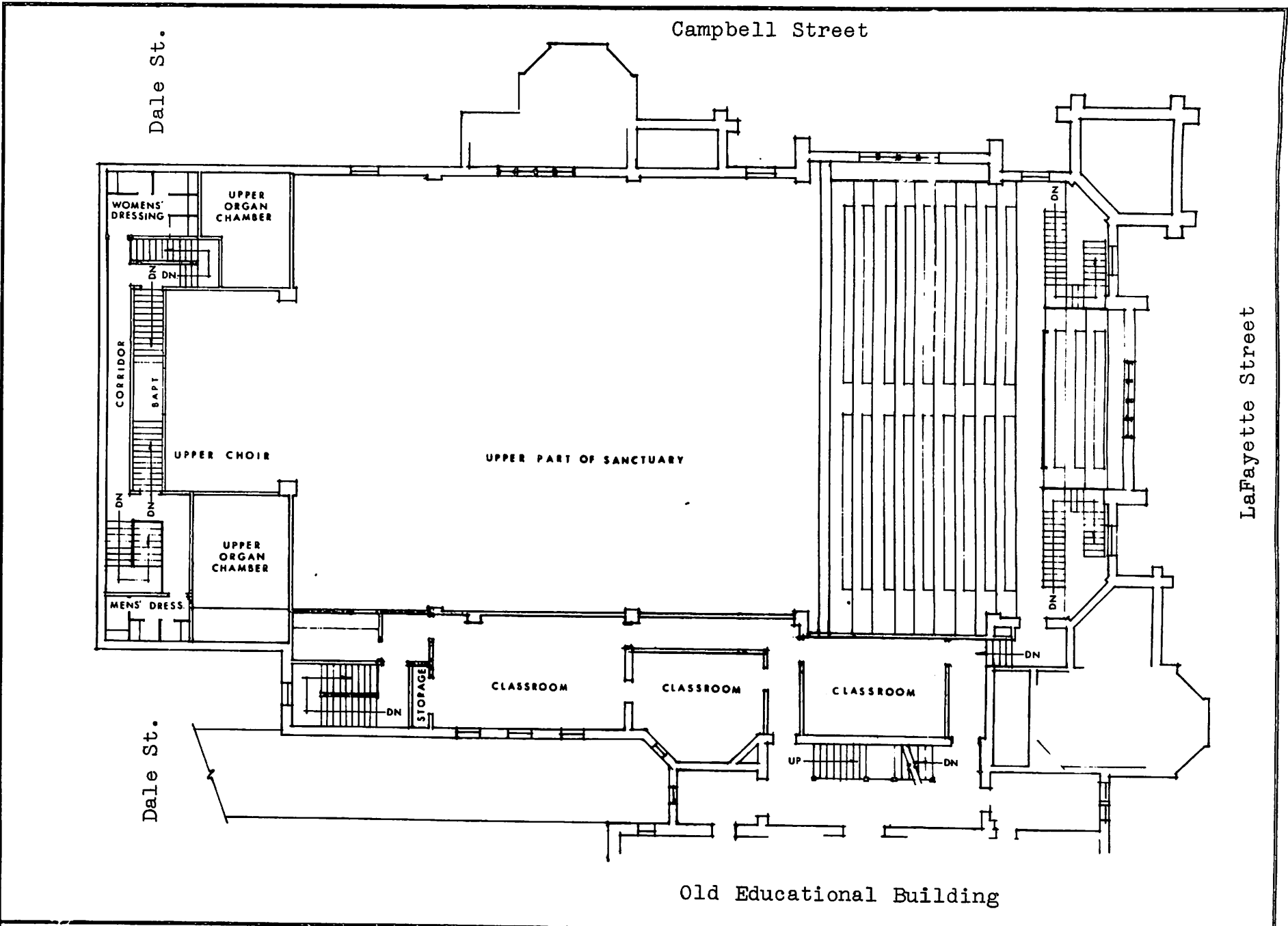

Campbell Street

Dale St.

LaFayette Street

WOMENS' DRESSING

UPPER ORGAN CHAMBER

CORRIDOR

BAPT

UPPER CHOIR

UPPER PART OF SANCTUARY

UPPER ORGAN CHAMBER

MENS' DRESS

CLASSROOM

CLASSROOM

CLASSROOM

STORAGE

Dale St.

Old Educational Building

**WILBER, KENDRICK, WORKMAN AND WARREN**  
ARCHITECTS  
CHARLOTTE, NORTH CAROLINA

**FIRST BAPTIST CHURCH**  
SHELBY, NORTH CAROLINA

SECOND FLOOR	REVISED	OMNEY NO.
	DATE JAN 14, 1971	3
	CONS. NO. 391	CP TOTAL 3

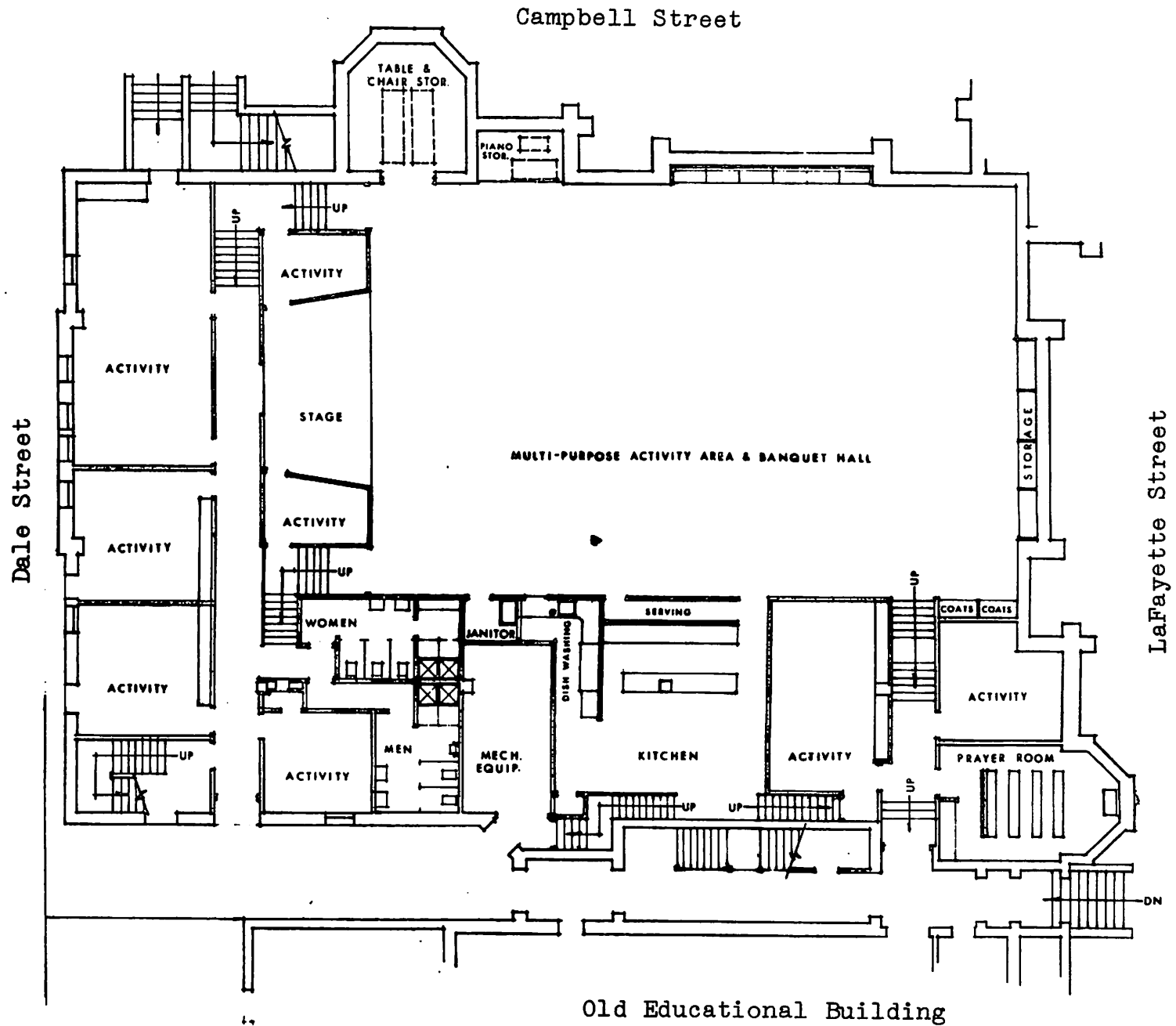

Old Educational Building

**WILBER, KENDRICK, WORKMAN AND WARREN**  
 ARCHITECTS  
 CHARLOTTE, NORTH CAROLINA

**FIRST BAPTIST CHURCH**  
 SHELBY, NORTH CAROLINA

REVISION	QUEST NO.
DATE JAN 14, 1971	1
COMM. NO. 391	OF TOTAL 3

GROUND FLOOR